

PARKING HANG TAGS

Many businesses and organizations utilize parking hang tags to keep their parking lots secure and to provide information to visitors. They are often used by schools, hospitals, apartment complexes, car rental companies, and corporate offices. These tags can be ordered in a variety of different material options and fully customized with reflective laminate, foil stamping, numbering, and barcoding.

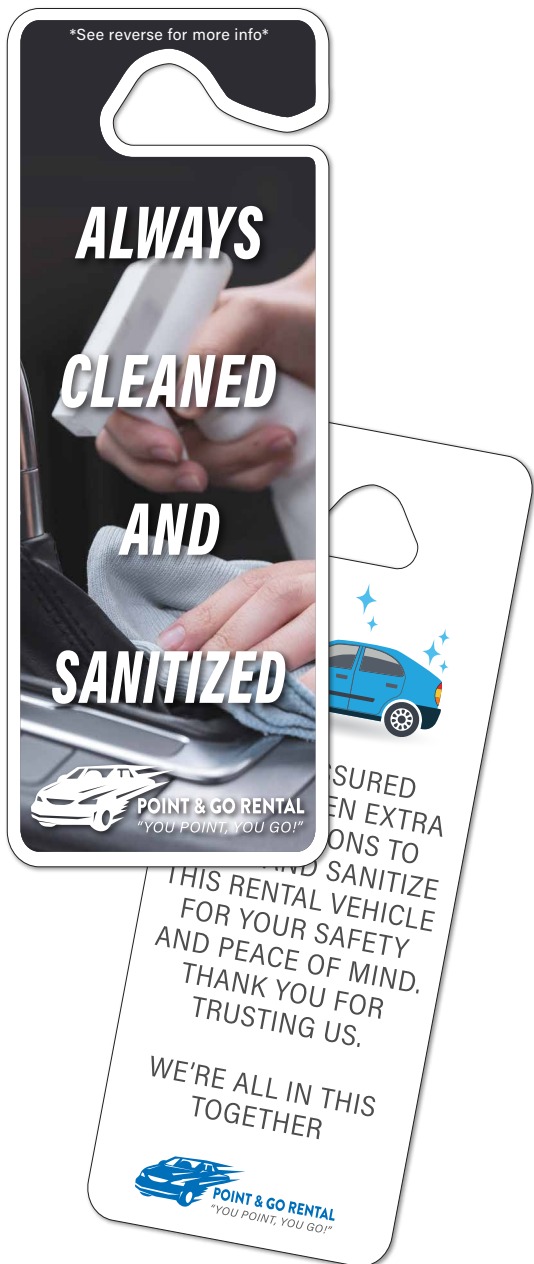

- Five Materials To Choose From!**
- .015" White Polyethylene
 - .035" White Polyethylene
 - .035" Recycled White Polyethylene
 - .035" Polyethylene with Reflective Overlaminate
 - .020" Deluxe Plastic



Hang Tags can be printed on .035" polyethylene that contains up to 70% post-consumer recycled materials. Look for the item numbers with an "E" after them.